

Round/Square Shower Set Instruction

IMPORTANT

Please read these instructions carefully and keep in a safe place for future reference. If you are unsure of any part of the instructions in this document then we recommend that you contact a reputable qualified trades person.

INTRODUCTION

The Model supplied may vary from the image shown below. Please note that the general installation process for all mini Shower Sets are the same and the following guide will take you through the process.

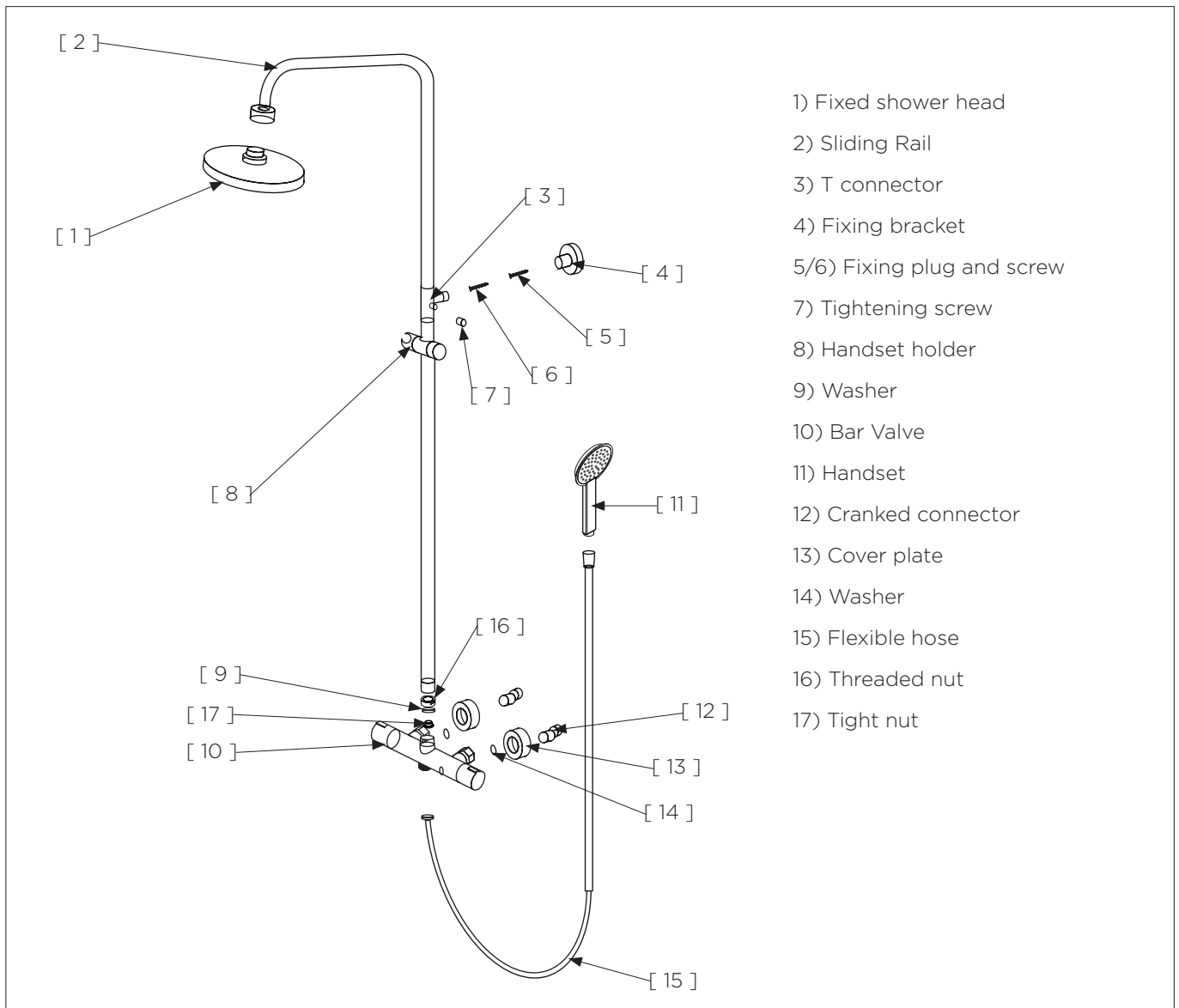

- 1) Fixed shower head
- 2) Sliding Rail
- 3) T connector
- 4) Fixing bracket
- 5/6) Fixing plug and screw
- 7) Tightening screw
- 8) Handset holder
- 9) Washer
- 10) Bar Valve
- 11) Handset
- 12) Cranked connector
- 13) Cover plate
- 14) Washer
- 15) Flexible hose
- 16) Threaded nut
- 17) Tight nut

BEFORE INSTALLATION

Warning: Before installing the new shower valve it is essential that you thoroughly flush through the pipework in order to remove any remaining swarf, solder, etc. Failure to carry out this procedure could cause problems or damage to the workings of the shower valve.

- 1) Turn off the mains water supply before commencing work.
- 2) Before installation identify all components and inspect the product for any damage. A claim will not be accepted if an obvious defect is found after installation.



BY CAVALIER BATHROOMS

Round Shower Set Instruction

INSTALLATION

- 1) Fit cranked connectors [12] to the water inlets in the wall.
- 2) Screw the cover plates [13] onto the cranked connectors until they come into contact with the wall.
Seal with suitable sealant.
- 3) Fix the connector of the shower bar valve [10] to the cranked connectors ensuring the hot inlet is on the left and cold inlet is on the right. Please use a cotton sheet inside the spanner when tightening the connectors to avoid scratching the surface.
- 4) Place the sliding rail assembly [2] in desired final position and measure the installation height of the shower set with tape. Mark the drilling positions for securing the fixing bracket [4] to the wall using a pencil.
- 5) Drill through marked positions on the wall then insert wall plugs into the wall holes.
- 6) Secure the fixing bracket [4] to the wall using screws.
- 7) Align the shower valve [10] and sliding rail assembly [2], Tighten the nuts using an adjustable spanner.
- 8) Fit tightening screw [7] into the fixing bracket using an allen key.
Secure the top end of the sliding rail assembly [2] to the fixing bracket [4] on the wall.
- 9) Connect top shower head, shower hose and hand shower.
- 10) Valve **MUST** be open when turning the mains water back on to ensure no debris is caught in the cartridges.
Check connections for watertightness.

** Fitting the Handset Holder

Prior to placing the handset holder onto the sliding rail, locate the tight nut [17] at the bottom of the sliding rail [2], first you need to loosen and remove this tight nut with an allen key. Once removed you will then be able to remove the threaded nut [16], unscrew this to enable the handset holder to be fitted without damaging the product. Once this has been fitted, re-attach the threaded nut and the tight nut using the allen key.

Guarantee

For full details of our guarantee please refer to our website. Our products are backed by a 10 year guarantee, this is only valid to customers who complete and submit the online Niagara® Guarantee Registration Form within 30 days of installation. Please note that products with finishes other than Chrome are guaranteed for 2 years only, these products must also be registered online to activate the 2 Year Guarantee. To register and activate your guarantee please visit www.niagarabathrooms.co.uk

Aftercare

Care **MUST** be taken when cleaning our products to avoid damaging the fitting or finish. To maintain the appearance of the fitting, please ensure it is cleaned regularly using only a clean soft damp cloth. Whilst all of our products are durable the finishes are vulnerable to some strong substances, we only recommend the use of warm soapy water, **DO NOT** use abrasive sponges, strong household cleaners, scouring agents, organic solvents or acidic cleaners as they may cause surface deterioration, peeling or change of colour.